

MIG WELDING TORCHES

XA15 MIG TORCH



XA15 MIG TORCH

Suregrip™ Series

180A AIR COOLED MIG WELDING TORCH

Rating: 180A CO₂ 150A mixed gas EN60974-7 @ 60% duty cycle. 0.6 to 1.0mm wires

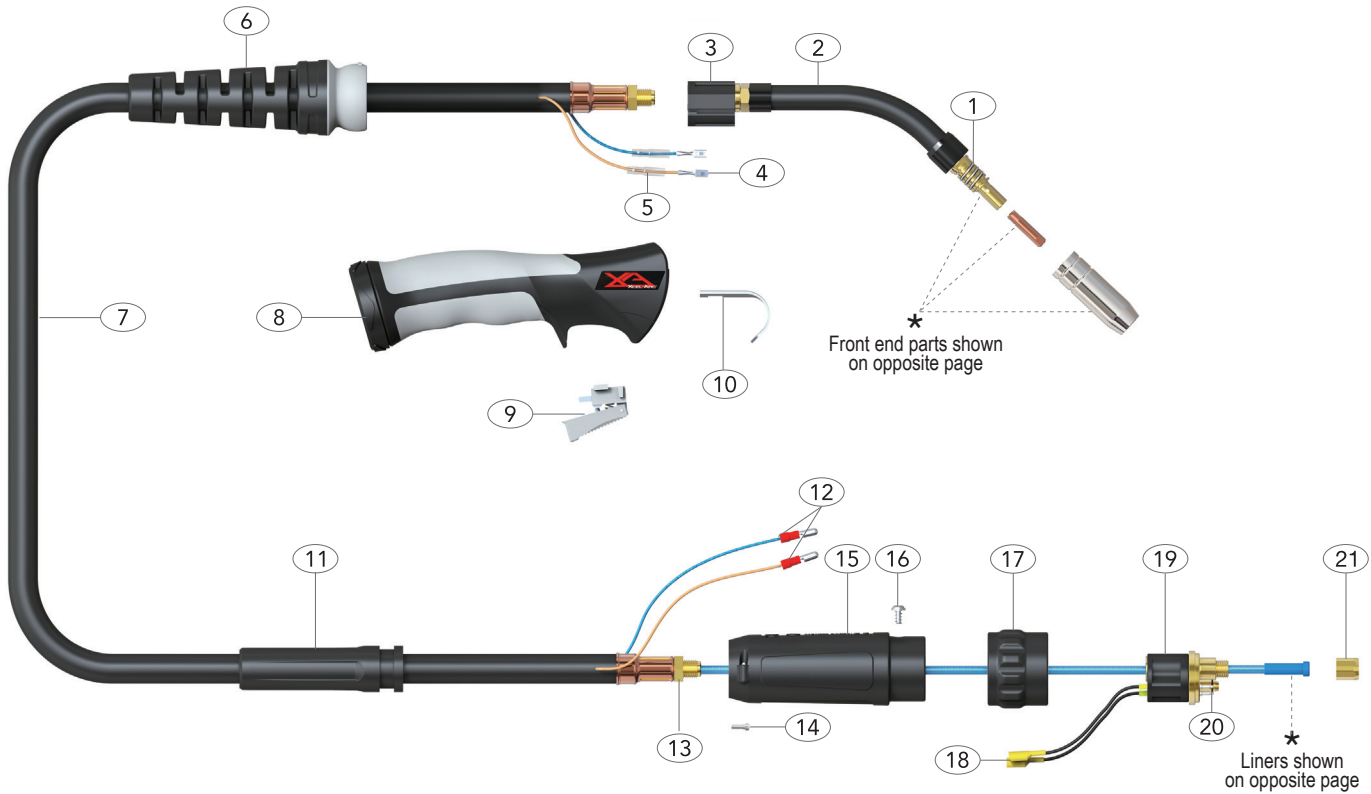

Torch Model			
Description	Part Number	4 Mt	5 Mt
XA Suregrip Ergo Torch Package	XA15-3	XA15-4	XA15-5

Spare Parts		
Part Number	Description	
1	XA1504	Nozzle Spring
2	XA1501	Swan Neck Assembly
3	XA1515	Ergo Handle Location Body
4	XA1521	Cable Terminal
5	XA1521-C	Cable Terminal Cover
6	XA8015	Cable Support C/W Ball Joint
7	XA1517-30	Hyperflex Cable Assembly X 3mt
	XA1517-40	Hyperflex Cable Assembly X 4mt
	XA1517-50	Hyperflex Cable Assembly X 5mt
8	XA2514	Ergo Handle Kit C/W Lock Nut
9	XA2516	Medium / Large Ergo Trigger
10	XA2517	Hanger Hook (optional extra)
11	XA2841	Cable Support
12	XA1522	Cable Terminal - Male
13	XA1505	Lock Nut
14	XASCSP1-1	Gun Plug Housing Screw
15	XASC2578/S	Gun Plug Housing

Spare Parts		
Part Number	Description	
16	XA1541	Gun Plug Screw
17	XA1519/P	Gun Plug Nut
18	XA1523	Gun Plug Terminal Female
19	XA1528	Gun Plug Body C/W Spring Pins
20	XA1524	Gun Plug 'O' Ring
21	XA1525	Liner Nut

MIG WELDING TORCHES

XA15 MIG TORCH



XA15 MIG TORCH CONSUMABLES

Suregrip™ Series

Front end consumables

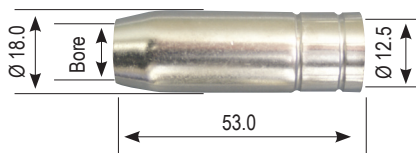
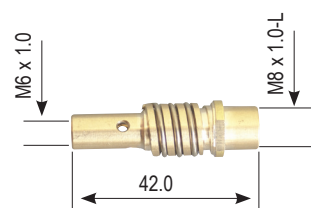
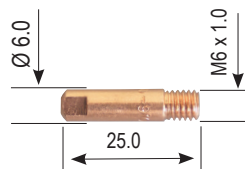

XA15 Contact Tips

Part Number	Description	Material
XA1527-06	Contact Tip 0.6mm D6 M6 x 25mm	Ecu
XA1527-08	Contact Tip 0.8mm D6 M6 x 25mm	Ecu
XA1527-09	Contact Tip 0.9mm D6 M6 x 25mm	Ecu
XA1527-10	Contact Tip 1.0mm D6 M6 x 25mm	Ecu
XA1527-12	Contact Tip 1.2mm D6 M6 x 25mm	Ecu

Tip Holder XA15

Part Number	Description	Tip Thread	Material
XA1507	XA15 Tip Holder (RH) L = 42.0mm	M6	Brass
XA1507LH	XA15 Tip Holder (LH) L = 42.0mm (supplied as standard)	M6	Brass

Nozzle Spring XA15

Part Number	Description
XA1504	XA15 Nozzle Spring

XA15 Gas Nozzle

Part Number	Description	Type	Bore Ø	Material
XA1529	XA15 Gas Nozzle	Cylindrical	16.0mm	Copper
XA1530	XA15 Gas Nozzle	Conical	12.0mm	Copper
XA1531	XA15 Gas Nozzle	Tapered	10.5mm	Copper
XA1532	XA15 Gas Nozzle	Bottle	12.8mm	Copper
XA1533	XA15 Gas Nozzle	Spot Weld	16.0mm	Copper

Liners



XA15 Liners

Part Number	Description
XA1535-30B	Insulated Liner 0.6-0.9mm wire x 3.4m (Blue)
XA1535-40B	Insulated Liner 0.6-0.9mm wire x 4.4m (Blue)
XA1535-50B	Insulated Liner 0.6-0.9mm wire x 5.4m (Blue)
XA2513-30B	Teflon Liner 1.0-1.2mm x 3.4m for Soft wire (Red)
XA2513-40B	Teflon Liner 1.0-1.2mm x 4.4m for Soft wire (Red)
XA2513-50B	Teflon Liner 1.0-1.2mm x 5.4m for Soft wire (Red)
XA2564-30	PA Liner 1.0-1.2mm x 3.4m for Soft & S/Steel wire, O.D = 4.0mm
XA2564-40	PA Liner 1.0-1.2mm x 4.4m for Soft & S/Steel wire, O.D = 4.0mm
XA3564-30	PA Liner 1.0-1.2mm x 3.4m for Soft & S/Steel wire, O.D = 4.7mm
XA3564-40	PA Liner 1.0-1.2mm x 4.4m for Soft & S/Steel wire, O.D = 4.7mm